

8/17/99

14-MAR-2024 14:05
R:\2024_Resurfacing
Mops\Wilkes\Primary\DK00379_Wilkes_resurfacing_typicals.dgn
\$\$\$\$\$REVISION\$\$\$\$\$

- "PATCHING EXISTING PAVEMENT" HAS BEEN INCLUDED AS A PAY ITEM ON MAPS. PATCHING MAY OR MAY NOT BE NEEDED DEPENDING ON CONDITION OF MAP SURFACE AT TIME THAT PAVING SEASON BEGINS. AREAS TO BE DELINIATED BY THE ENGINEER.
- INCIDENTAL MILLING AT LOCATIONS AS DIRECTED BY THE ENGINEER

PROJECT REFERENCE NO. DK00379	SHEET NO. 01
----------------------------------	-----------------

PAVEMENT SCHEDULE	
C1	PROP. APPROX. 1½" ASPHALT CONCRETE SURFACE COURSE, TYPE S9.5C, AN AVERAGE RATE OF 168 LBS. PER SQ. YD.
T	SHOULDER RECONSTRUCTION
U	EXISTING PAVEMENT
V1	INCIDENTAL MILLING (See Tie in Detail)

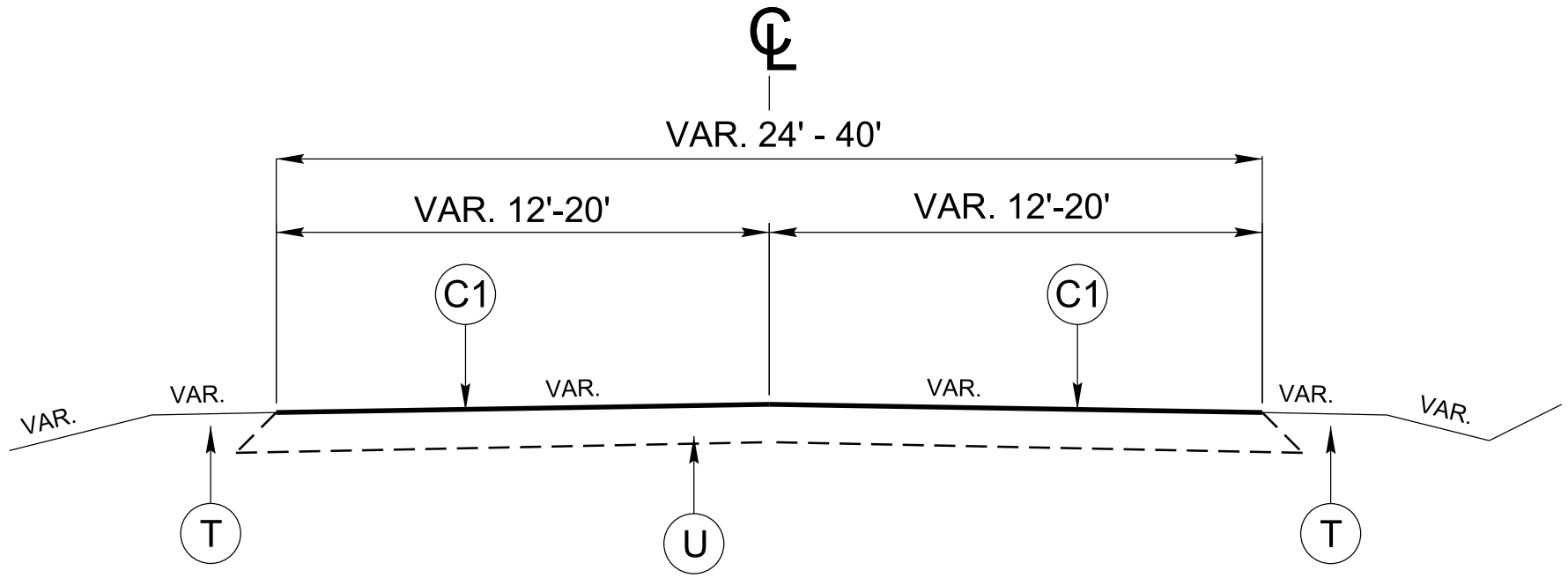

TYPICAL SECTION NO. 1
MAP 1 - US 21 N FROM SURRY CO LINE TO SR 1900

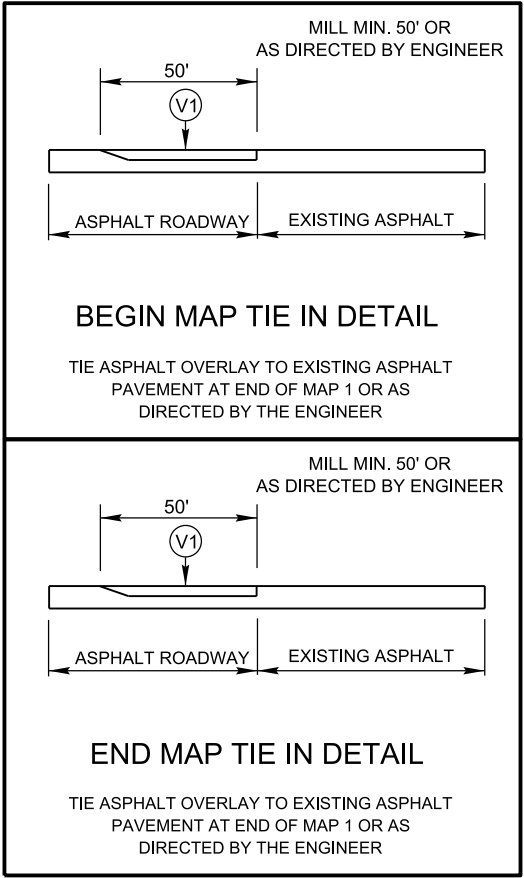

NOTE: TYPICALS ARE NOT TO SCALE

WILKES COUNTY PRIMARY ROADS 2024 ASPHALT RESURFACING													
<table border="1" style="width: 100%;"> <thead> <tr> <th>REVISIONS</th> <th>INT.</th> <th>DATE</th> </tr> </thead> <tbody> <tr><td> </td><td> </td><td> </td></tr> <tr><td> </td><td> </td><td> </td></tr> <tr><td> </td><td> </td><td> </td></tr> </tbody> </table>			REVISIONS	INT.	DATE								
REVISIONS	INT.	DATE											
N.C. DEPARTMENT of TRANSPORTATION DIVISION of HIGHWAYS DIVISION ELEVEN		<table border="1" style="width: 100%;"> <tr> <td>SCALE: N/A</td> <td>DATE: 3/13/2024</td> </tr> <tr> <td>PREPARED BY: DLH</td> <td> </td> </tr> <tr> <td>REVIEWED BY: </td> <td> </td> </tr> <tr> <td> </td> <td> </td> </tr> </table>	SCALE: N/A	DATE: 3/13/2024	PREPARED BY: DLH		REVIEWED BY:						
SCALE: N/A	DATE: 3/13/2024												
PREPARED BY: DLH													
REVIEWED BY:													

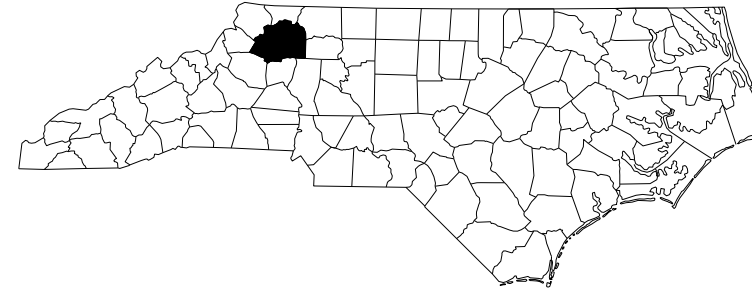

WILKES COUNTY

TYPE OF WORK: ASPHALT RESURFACING
MAP # 1

2024

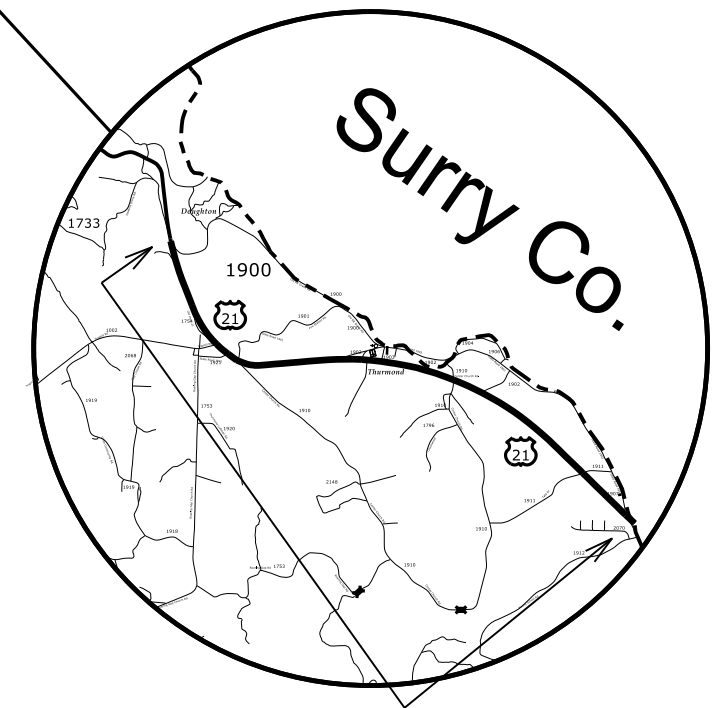
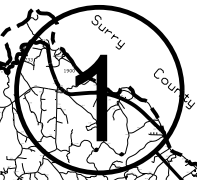
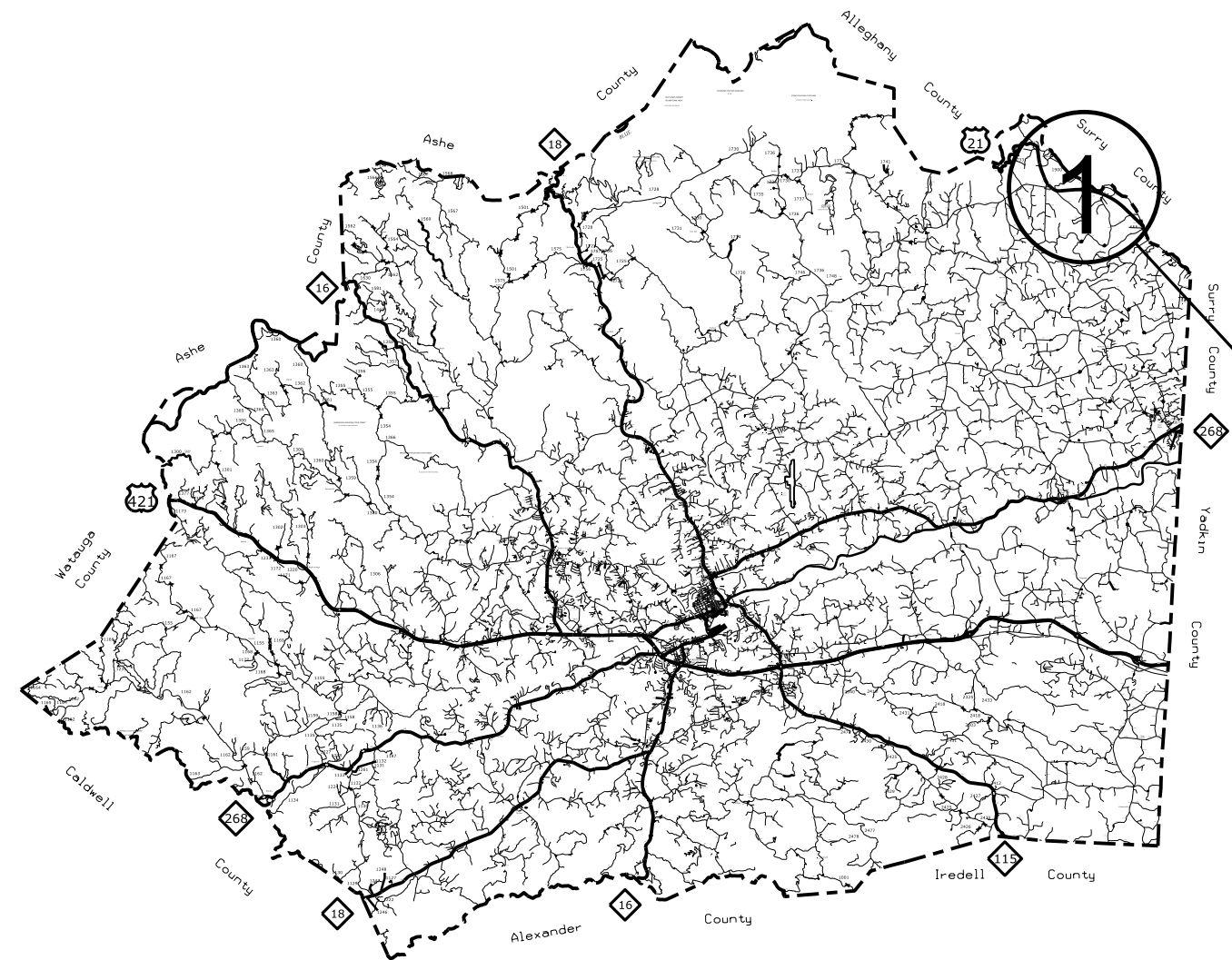

* US 21 N - (4.26mi.)
(FROM SURRY CO. LINE TO SR 1900)

PROJECT NO.	SHEET NO.
DK00379	3

SUMMARY OF QUANTITIES

PROJECT NO	COUNTY	MAP NO	ROUTE	DESCRIPTION	TYP NO	LANES	LANE TYPE	LENGTH	WIDTH	BEGIN MP	END MP	122000000-E	124500000-E	126000000-E	133000000-E	152300000-E	157500000-E	170400000-E
												INCIDENTAL STONE BASE	SHOULDER RECONSTRUCTION	AGGREGATE SHOULDER BORROW	INCIDENTAL MILLING	SURFACE COURSE, S9.5C	ASPHALT BINDER FOR PLANT MIX	PATCHING EXISTING PAVEMENT
							MI	FT				TONS	SMI	TON	SY	TONS	TON	TONS
2024CPT.11.07.10971	Wilkes	1	US-21 N / US HWY 21	FROM SURRY CO LINE TO SR 1900	1	2	2WU	4.26	27	0.08	4.34	85	8.52	1,172	600	6,549	467	1,670
TOTAL FOR PROJ NO. 2024CPT.11.07.10971							4.26					85	8.52	1,172	600	6,549	467	1,670
GRAND TOTAL							4.26					85	8.52	1,172	600	6,549	467	1,670

[GOINC Milepost Map](#)

PROJECT NO.	SHEET NO.
DK00379	4

THERMOPLASTIC AND PAINT QUANTITIES

PROJECT NO	COUNTY	MAP NO	ROUTE	DESCRIPTION	TYP NO	LANES	LANE TYPE	LENGTH	WIDTH	BEGIN MP	END MP	4413000000-E	4695000000-E	4695000000-E	4725000000-E		4890000000-E	4905100000-N
												WORK ZONE ADVANCE/GENERAL WARNING SIGNING	THERMOPLASTIC PAVEMENT MARKING LINES, 8", 90 MIL	THERMOPLASTIC PAVEMENT MARKING LINES, 24", 90 MIL	THERMOPLASTIC LEFT ARROW 90 MIL	THERMOPLASTIC RIGHT ARROW 90 MIL	GENERIC MARKING ITEM HOT SPRAY THERMOPLASTIC PAVEMENT MARKING LINES, 4", 55 MIL	NON-CAST IRON SNOWPLOWABLE PAVEMENT MARKER
								MI	FT			SF	LF	LF	EA	EA	LF	EA
2024CPT.11.07.10971	Wilkes	1	US-21 N / US HWY 21	FROM SURRY CO LINE TO SR 1900	1	2	2WU	4.26	27	0.08	4.34	262	1,050	80	12	7	91,675	500
TOTAL FOR PROJ NO. 2024CPT.11.07.10971								4.26				262	1,050	80	12	7	91,675	500
GRAND TOTAL								4.26				262	1,050	80	12	7	91,675	500
															19			

[GO!NC Milepost Map](#)

SIGNING FOR RESURFACING PROJECTS

LEGEND
 ┆ STATIONARY SIGN
 ← DIRECTION OF TRAFFIC FLOW

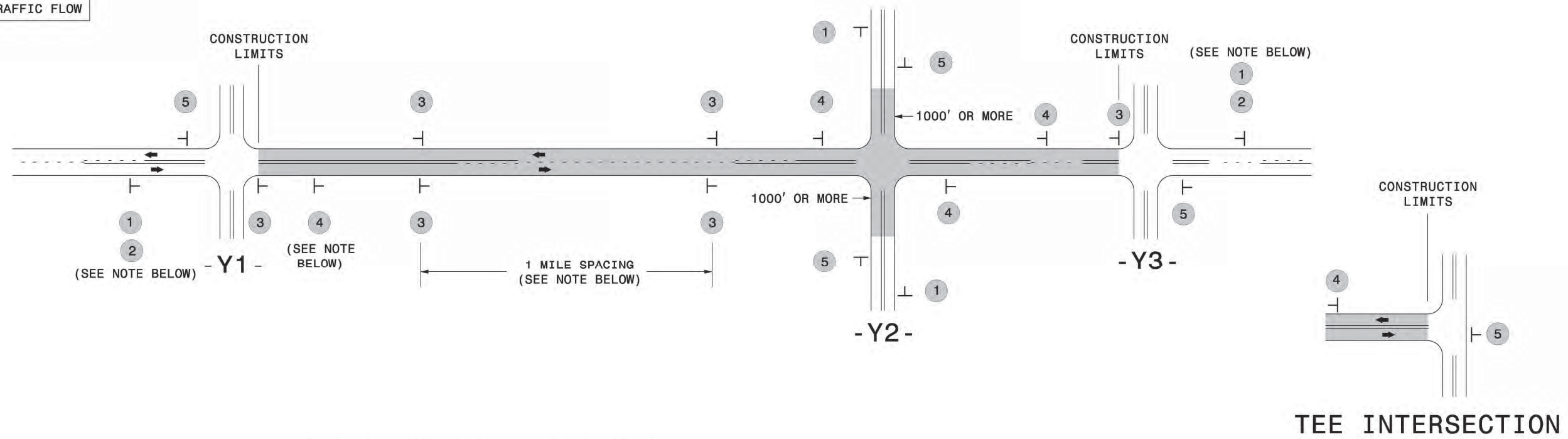

MAINLINE (-L-) SIGNING

-Y- LINE SIGNING

SIGNING NOTES AND PLACEMENT PER DIRECTION	1	 <small>W20-1 48" X 48"</small>	PLACE 1000' PRIOR TO BEGINNING OF CONSTRUCTION LIMITS. ONLY USED ON -Y- LINES IF RESURFACING LIMITS EXTEND 1000' ALONG -Y- LINE.	
	2	 <small>W7-3aP 24" X 18"</small>	#2 SIGN ONLY USED WHEN CONSTRUCTION LIMITS ARE 2 OR MORE MILES IN LENGTH. ROUND UP TO NEXT WHOLE NUMBER. (NO FRACTIONAL OR DECIMAL NUMBERS)	
	3	 <small>SP 13107 48" X 48"</small>	<ul style="list-style-type: none"> - PLACE INITIALLY AT THE CONSTRUCTION LIMITS AND SPACE 1 MILE APART THEREAFTER. - AT TEE INTERSECTIONS INSTALL INITIALLY 1/2 MILE FROM INTERSECTION AND SPACE 1 MILE APART THEREAFTER. 	
	4	 <small>SP 13106 48" X 48"</small>	<ul style="list-style-type: none"> - THESE ARE FOR -Y- LINES THAT ARE "THROUGH" ROADWAYS. - DEAD END AND SUBDIVISION ROADS ARE NOT "THROUGH" ROADWAYS. - INSTALL 500' +/- FROM EACH -Y- LINE APPROACH AS SHOWN ABOVE. - FOR MULTIPLE -Y- LINES THAT ARE SEPARATED BY 0.25 MILES OR LESS, TREAT AS A SINGLE UNIT AND INSTALL WITHIN 500' OF EACH APPROACH. - A MAXIMUM OF 2 SIGN SETS PER MILE. DO NOT INSTALL WHEN -Y- LINES ARE WITHIN 0.5 MILES FROM "END ROAD WORK" SIGN. - FOR TEE INTERSECTIONS, INSTALL WITHIN 500' +/- OF THE INTERSECTION ALONG -L- LINE. 	
	5	 <small>G20-2 A 48" X 24"</small>	PLACE 500' FOLLOWING THE END OF CONSTRUCTION LIMITS OR AS SHOWN WHEN WORK ENDS AT A 3-WAY TEE INTERSECTION.	

NO REQUIRED STATIONARY SIGNING FOR THE FOLLOWING -Y- LINE CONDITIONS:

- 1) LESS THAN 1000' OF RESURFACING ALONG -Y- LINE
- 2) SUBDIVISION ROADS
- 3) DEAD END ROADS

WHEN PAVING/CONSTRUCTION ACTIVITIES PROCEED ACROSS AN UNSIGNED -Y- LINE, PORTABLE ADVANCE WARNING SIGNS SHALL BE USED ALONG THE -Y- LINE AS SHOWN BELOW. REMOVE UPON COMPLETION OF WORK.

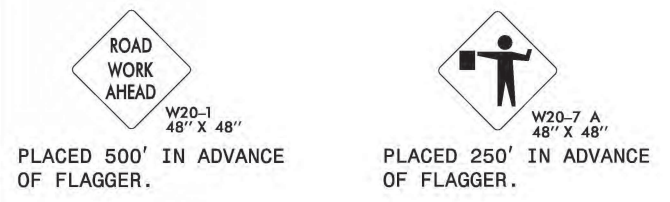

MAPS LESS THAN 2 MILES

FOR RESURFACING MAPS WITH CONSTRUCTION LIMITS LESS THAN 2 MILES IN LENGTH, NO STATIONARY SIGNS ARE REQUIRED. USE PORTABLE "ROAD UNDER CONSTRUCTION" OR "ROAD WORK AHEAD" SIGNS IN LIEU OF STATIONARY ADVANCE WARNINGS SIGNS.

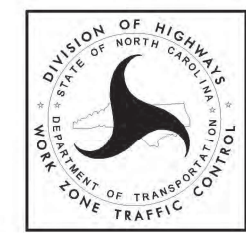

**ADVANCE WARNING SIGNS
FOR
RURAL AND SUBURBAN
2-LANE ROADWAY
RESURFACING**

5/15/2017 5:11:10 PM \\S:\T\WZTC\Resurfacing\2L2W & AST Resurfacing Details\Resurfacing_AdvWarn_2Ln.dgn User:keads

- NOTES:
- 1) DETAIL DOES NOT APPLY TO OGAFc AND ULTRA-THIN BONDED WEARING COURSE.
 - 2) BACKFILL SHOULDER WITH APPROVED MATERIAL.
 - 3) THE SHOULDER WEDGE DEVICE MAY BE DISENGAGED AT PAVED DRIVEWAYS AND SIDE STREETS.

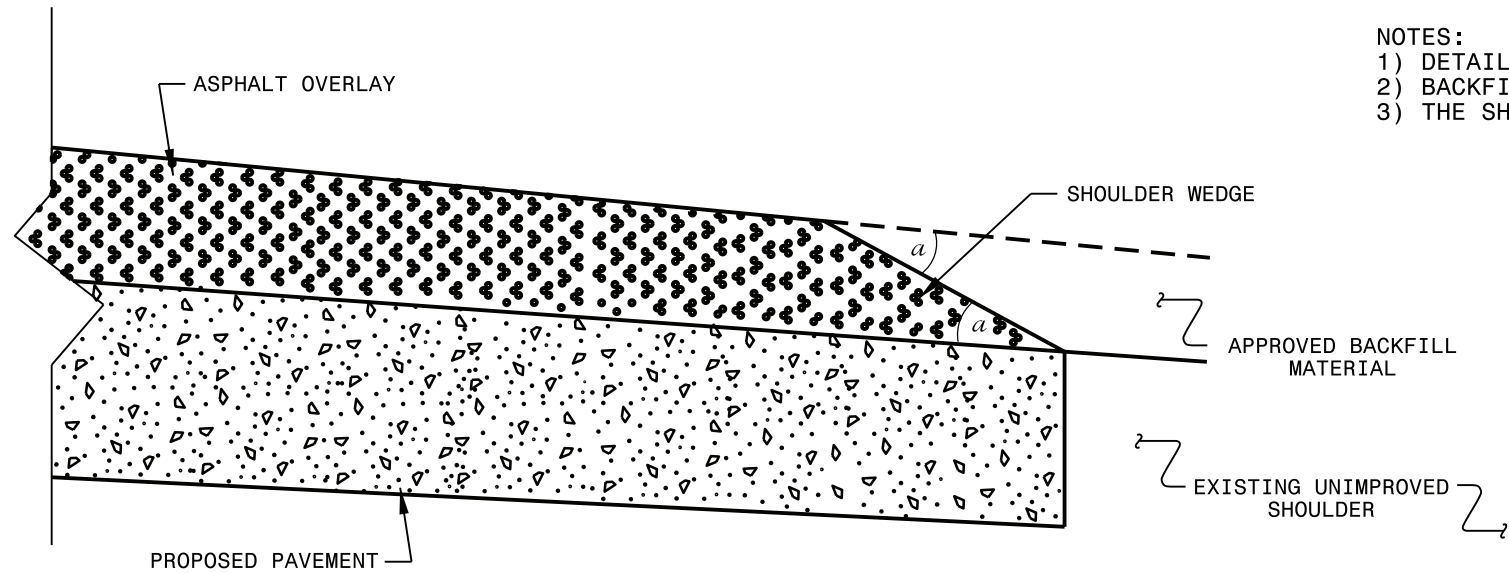

SHOULDER WEDGE DETAIL
(Resurfacing Projects w/ Widening or
with Existing Paved Shoulder having no dropoffs)

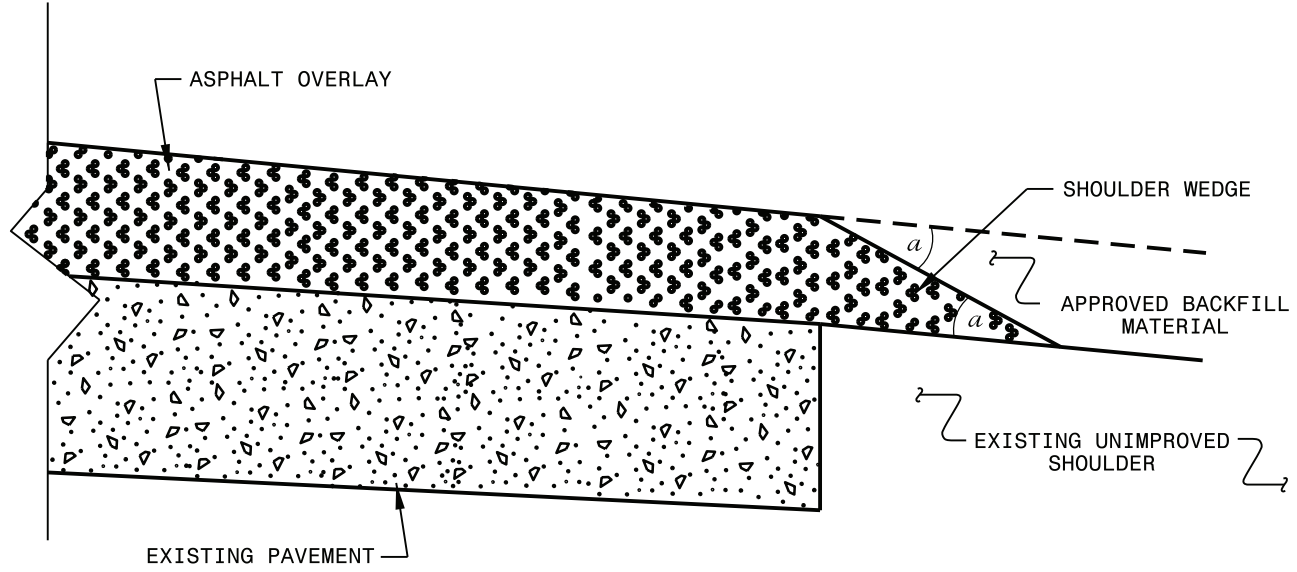

SHOULDER WEDGE DETAIL
(Resurfacing Projects w/ NO Widening)

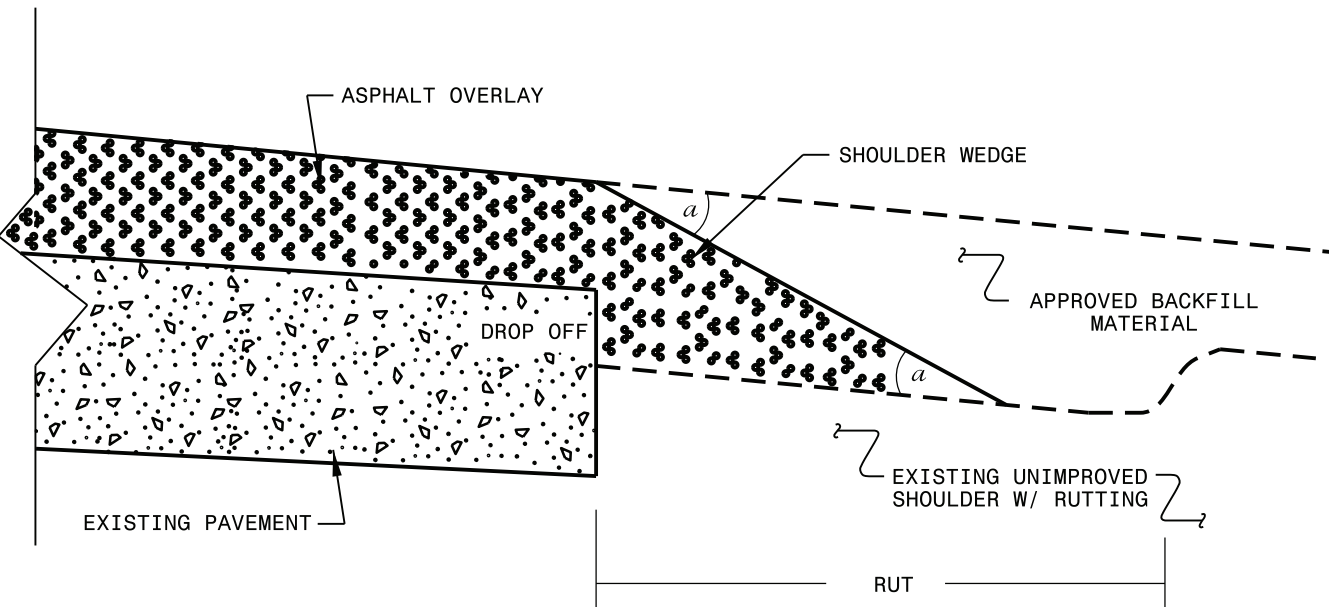

SHOULDER WEDGE DETAIL
(Resurfacing Adjacent to
Rutted Shoulder)

- SHOULDER WEDGE ANGLE = 30°

CONTRACT STANDARDS AND DEVELOPMENT UNIT			
Office 919-707-6950		FAX 919-250-4119	
SHOULDER WEDGE DETAILS			
ORIGINAL BY: T.SPELL	DATE: 7-19-11		
MODIFIED BY:	DATE: 10/16/12		
CHECKED BY:	DATE:		
FILE SPEC.: susr/details/stand/shoulderwedgedetail.dgn			

SYSTEMS DESIGN USER NAME